

Product Data Sheet



2XX Series SP

Replace "XX" with 01 through 30 for number of poles

Terminal Block— Closed Back
With Sems Pressure Saddle Screw
20 Amps, 250 Volts (AC/DC)



(6 Pole shown)

Copper Stranded Wire only.

Wire Range with Wire Binding Screw: #12 - #22 AWG

7/16" Centers

Application torque: 12 in. lbs

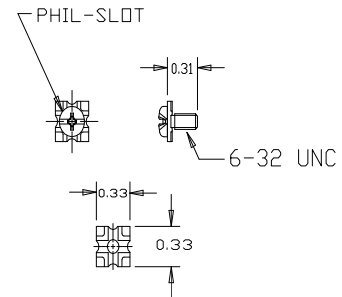

Electrical Ratings:

- 20A with Listed ring lug or unprepared wire, (Based on NEC Table 310-16, 75°C columns)
- 250 Volts AC/DC (UL 1059 Class B, User Group – Commercial Appliances)
- Short Circuit Current Rating: 10,000A (Default)
- Approved for Factory and Field Wiring.

Mechanical Ratings:

- Storage and transportation temperature range: -35 °C to 110 °C (-31 °F to 230 °F)*
 - Maximum insulator base temperature: 150 °C (302 °F)* UL RTI
 - Flammability rating of insulator base: UL 94V-1
- * Use outside these ratings needs to be judged in the end-use application.

Materials:

- Connector (Contact): Brass, tin plated.
- Insulator base: Phenolic
- Drive screw (Rivet): Stainless steel
- Screw, #6-32 Saddle Plate, Phil-Slot: Steel, nickel plated

Agency Approvals:

- UL Recognized, UL 1059 Terminal Block Standard, File No. XCFR2.E62806
- CSA Certified, CSA C22.2 No. 158, File No. LR19766
- CE compliant, IEC 60947-7-1
- RoHS Compliant

Wire Range:

| Wire Size | Torque | Copper Wire Stranding Classes - Number of Strands | | |
|-----------|------------|---------------------------------------------------|---------|---------|
| | | Solid | Class B | Class C |
| 12 | 12 in. Lbs | | 7 | 19 |
| 14 | 12 in. Lbs | | 7 | 19 |
| 16 | 12 in. Lbs | | 7 | 19 |
| 18 | 12 in. Lbs | | 7 | 19 |
| 20 | 12 in. Lbs | | 7 | 19 |
| 22 | 12 in. Lbs | | 7 | 19 |

Suggested product mounting hardware: #6 fastener, torque to 10-15 in. lbs.

ACCESSORIES:

- Printing (for printing options, see Terminal Block Printing on website)
- Marking strips - sub mounted, black only (FB) (For Printing Options, see section on website)
- Marking strips – top mounted, white only (SW)



- Cover – top mounted. Order CW (white) or CB (Black). Can be printed. See website.

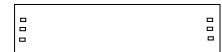

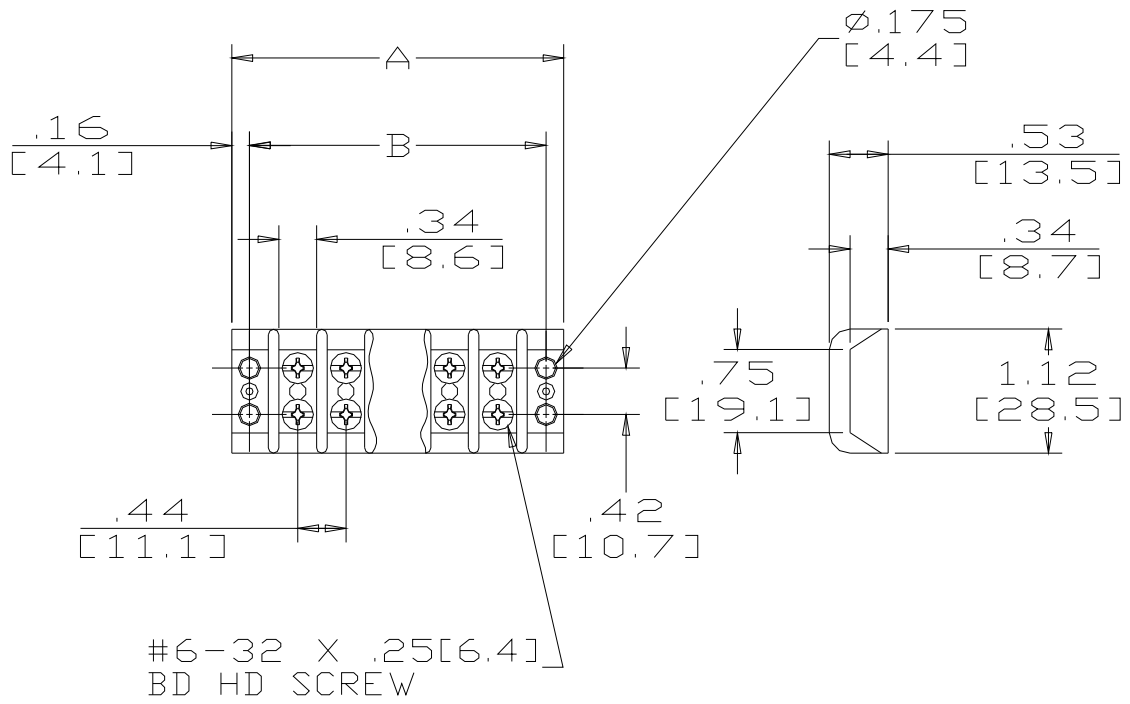

| Catalog No | # of Poles | Dimensions | | X | Catalog No | # of Poles | Dimensions | |
|------------|------------|------------|------|---|------------|------------|------------|-------|
| | | A | B | | | | A | B |
| 201 | 1 | 1.19 | 0.88 | X | 216 | 16 | 7.75 | 7.44 |
| 202 | 2 | 1.62 | 1.31 | X | 217 | 17 | 8.19 | 7.88 |
| 203 | 3 | 2.06 | 1.75 | X | 218 | 18 | 8.62 | 8.31 |
| 204 | 4 | 2.50 | 2.19 | X | 219 | 19 | 9.06 | 8.75 |
| 205 | 5 | 2.94 | 2.63 | X | 220 | 20 | 9.50 | 9.19 |
| 206 | 6 | 3.37 | 3.06 | X | 221 | 21 | 9.93 | 9.62 |
| 207 | 7 | 3.81 | 3.50 | X | 222 | 22 | 10.37 | 10.06 |
| 208 | 8 | 4.25 | 3.94 | X | 223 | 23 | 10.81 | 10.50 |
| 209 | 9 | 4.68 | 4.37 | X | 224 | 24 | 11.24 | 10.93 |
| 210 | 10 | 5.12 | 4.81 | X | 225 | 25 | 11.68 | 11.37 |
| 211 | 11 | 5.56 | 5.25 | X | 226 | 26 | 12.12 | 11.81 |
| 212 | 12 | 5.99 | 5.68 | X | 227 | 27 | 12.55 | 12.24 |
| 213 | 13 | 6.43 | 6.12 | X | 228 | 28 | 12.99 | 12.68 |
| 214 | 14 | 6.87 | 6.56 | X | 229 | 29 | 13.43 | 13.12 |
| 215 | 15 | 7.31 | 7.00 | X | 230 | 30 | 13.86 | 13.55 |

MM = Dim X 25.4